

Double switched power socket for cash till and single outlet back box for data EPOS systems.

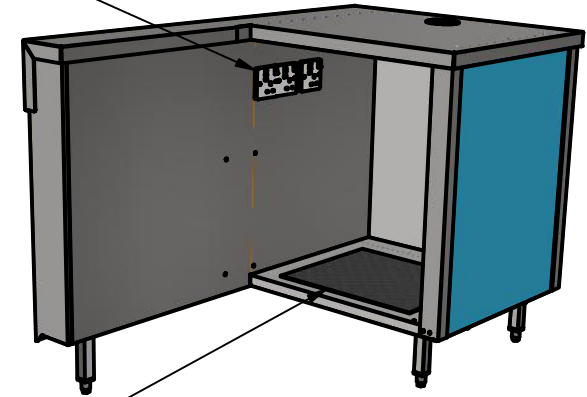

Foot rest with rubber mat

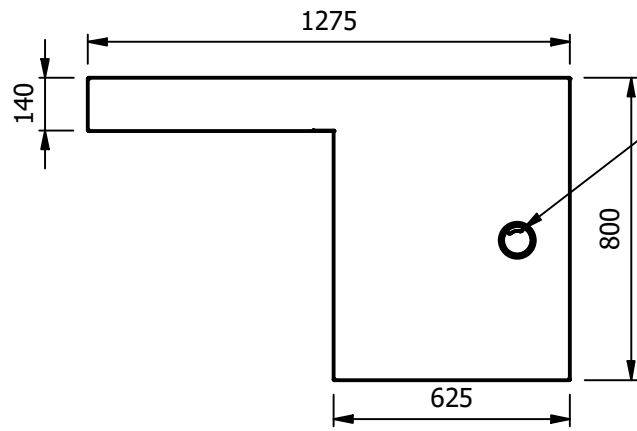
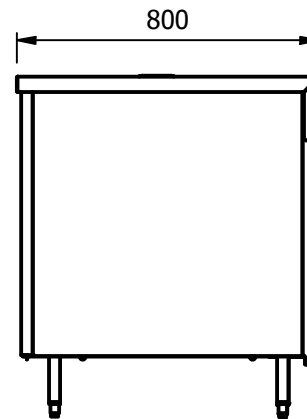
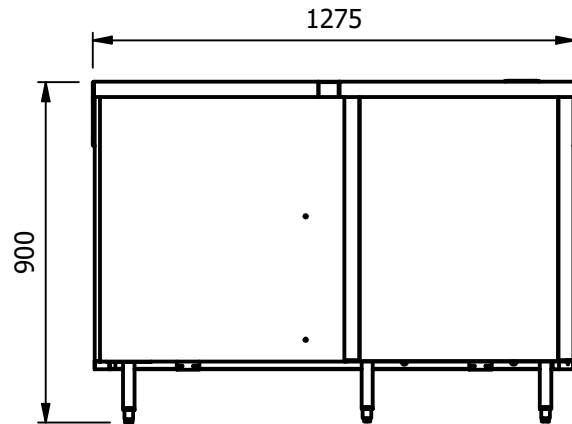

**Moffat Specification**

Cashier Section (Left hand configuration)  
Solid stainless steel Worktop provides a clean point of sales area.

Dimensions

Width - 1275mm  
Depth - 800mm  
Height - 900mm  
Weight - 65kg

Power Rating

2.9 [13amp Double socket]  
complete with a 2m long cord set & 13amp plug

Materials

1.2mm 304 Grade St/ Steel Top & Supports  
0.7mm 430 Grade St/ Steel Internal Structure

ALL SHEET METAL DIMENSIONS ARE I/S (INSIDE SIZES) (UNLESS OTHERWISE STATED)

ALL DIMENSIONS IN (mm), TOLERANCE = LINEAR ± 0.5mm, ANGULAR ± 0.5mm (OR AS STATED). ALL SHARP EDGES TO BE REMOVED FROM SHEET METAL PARTS

Product	COUNTERS			Product No							
Description	CLCS-8										
Material/Finish	Thickness			Desp/Date							
Legacy P/N	Weight	65kg		Quote No.	Dwg No.	CTRP-114215-1		Issue			
Client				SO Number	N/A		Drawn By	N.Raymen			
Client Project				Approved By			Date	13/04/2022			
E & R MOFFAT LTD, SEABEGS ROAD, BONNYBRIDGE, FK4 2BS, T: +44 (0)1324 812272, E: sales@ermoffat.co.uk, Web: www.ermoffat.co.uk							Scale	1 : 20	Sheet	1 / 2	A4

No reproduction or publication of this drawing may be made, and no article may be manufactured or assembled in accordance with this drawing without prior written consent. This prohibition is a term of any contract relating to this drawing. Rights reserved under the Copyright Act 1956 as amended by the Design Copyright Act 1968.

