

Important Design Parameters

Allowances must be made for air venting.
 The under slung compressor must have an unrestricted air flow.
 Proper venting must be provided ensuring cool air from the room can be drawn in through the condensing coil and out the other side.

Warning

Do not install unit in draughty conditions where the air movement is greater than 0.2mtr/sec.
 e.g. near entrance/exit doors, open windows, under air conditioning units or a ceiling mounted fan
 Do not install units where there is high radiated heat, e.g. direct sunlight, room heaters, or bright spot lights.
 Ambient room conditions must not exceed 25°C or a relative humidity of 60%.
 Blocked vents will cause reduced refrigeration efficiency and lead to malfunction

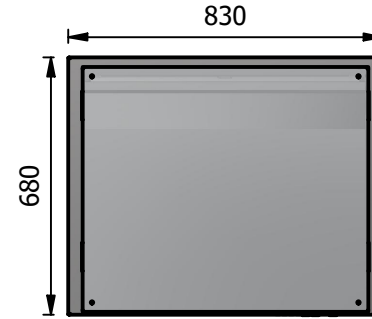

NOTE:- Serving height for children up to 12 years of age.
 This model is available with a work top height of 800mm and a Trayslide height of 773mm.
 Please add "B" to the end of the product code.

Moffat Specification

Dimensions
 Width - 830mm
 Depth - 680mm
 Height - 1655mm
 Weight - 110kg
 Well - 656mm x 495mm x 130mm
 Shelves - 724mm x 285mm

Power Rating

1.5kw
 complete with a 2m long cord set & 13amp plug

Materials

0.7mm 430 Grade St/Steel Gantry Hood
 1.2mm 304 Grade St/ Steel Top & Supports
 1.2mm 430 Grade St Steel Ancillary Parts
 6mm Tempered Glass
 LED Illumination

Installation

All swivel castors, two braked

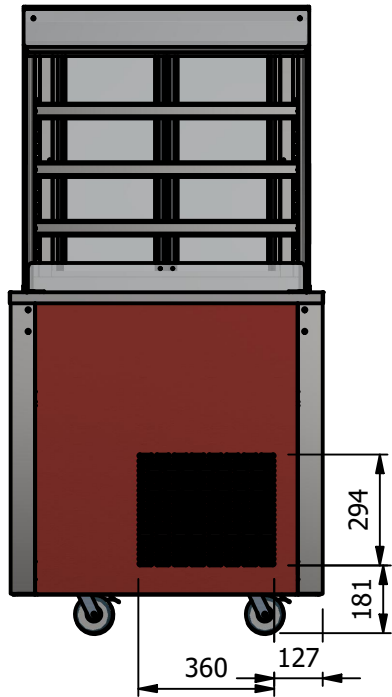

Note:- Size 2 models have straight through ventilation and can not be position up against a wall

Warning
 A clear space of 600mm must be left in front of this unit

AirFlow>>

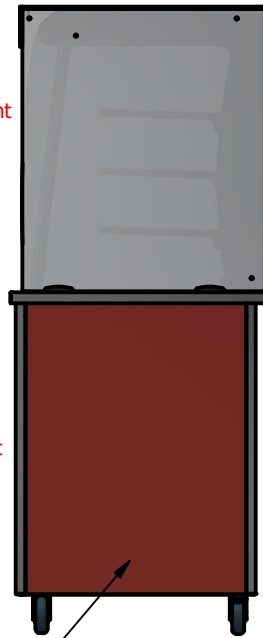

Warning
 A clear space of 100mm must be left at the rear

AirFlow>>

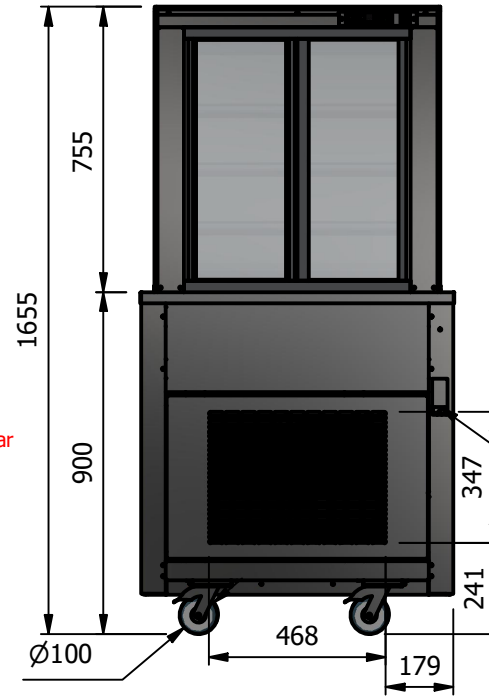

POWER CABLE ENTRY POINT

Front & End Panel
 Colour T.B.C

ALL SHEET METAL DIMENSIONS ARE I/S (INSIDE SIZES) (UNLESS OTHERWISE STATED)

ALL DIMENSIONS IN (mm), TOLERANCE = LINEAR ± 0.5mm, ANGULAR ± 0.5mm (OR AS STATED). ALL SHARP EDGES TO BE REMOVED FROM SHEET METAL PARTS

Product	VERSICARTE			Product No							
Description	*** VC2RDSL ***						<p>The Catering Equipment Company</p>				
Material/Finish	Thickness			Desp/Date							
Legacy P/N	Weight	110kg		Quote No.			Dwg No.	VCP-062498	Issue		
Client				SO Number	STANDARD		Drawn By	ABB		-	
Client Project				Approved By			Date	05/07/2023			
E & R MOFFAT LTD, SEABEGS ROAD, BONNYBRIDGE, FK4 2BS, T: +44 (0)1324 812272, E: sales@ermoffat.co.uk, Web: www.ermoffat.co.uk							Scale	1 : 20	Sheet	1 / 2	A4

No reproduction or publication of this drawing may be made, and no article may be manufactured or assembled in accordance with this drawing without prior written consent. This prohibition is a term of any contract relating to this drawing. Rights reserved under the Copyright Act 1956 as amended by the Design Copyright Act 1968.